



HEOLTYDRAW

BARRY



# HEOLTYDRAW

BARRY, CF62 5DU

£315,000 - FREEHOLD



3 Bedroom(s)



2 Bathroom(s)



1231.00 sq ft

Situated in the highly sought after West Quay estate in Barry, this impressive end terrace townhouse combines modern comfort with stylish living. Featuring three generous double bedrooms, the property offers an ideal layout for families or anyone seeking additional space. Two contemporary bathrooms provide convenience and practicality for all occupants.

A true highlight of the home is the breathtaking direct view over Barry Docks, enjoyed from two spacious balconies. These outdoor areas are perfect for relaxing with a coffee or simply taking in the serene waterfront scenery.

The location is equally appealing, within walking distance of local shops, schools, and public transport, ensuring everyday essentials and commutes are easily managed. Barry Island's beautiful beaches are just a short stroll away, offering plenty of opportunities for leisure and recreation.

Additional benefits include two private off road parking spaces, adding to the convenience of this exceptional home.

This townhouse is more than just a property; it represents a modern lifestyle, perfectly balancing tranquillity, style, and accessibility. Whether you're looking for a new family home or a sound investment, this is an opportunity not to be missed.



84 High Street  
Barry  
Vale of Glamorgan  
CF62 7DX  
TEL: 01446 700222  
EMAIL: [sales@knights.uk.com](mailto:sales@knights.uk.com)





#### HALLWAY

1.75m x 4.88m (5'09" x 16'0" )

#### KITCHEN

2.74m x 5.21m (9'0" x 17'01" )

#### DINING ROOM

2.87m / 2.08m x 4.62m / 2.77m (9'05" / 6'10" x 15'02" / 9'01" )

#### W/C

1.04m x 1.75m (3'05" x 5'09" )

#### LOUNGE

3.23m x 4.60m (10'07" x 15'01" )

#### BATHROOM

2.11m x 1.68m (6'11" x 5'06" )

#### BEDROOM TWO

2.69m x 4.39m (8'10" x 14'05" )

#### BEDROOM ONE

3.28m x 4.62m (10'09" x 15'02" )

#### EN-SUITE

2.03m / 1.09m x 1.75m (6'08" / 3'07" x 5'09" )

#### BEDROOM THREE

2.74m x 4.60m (9'0" x 15'01" )



Heol Ty Draw, Barry, CF62 5DU

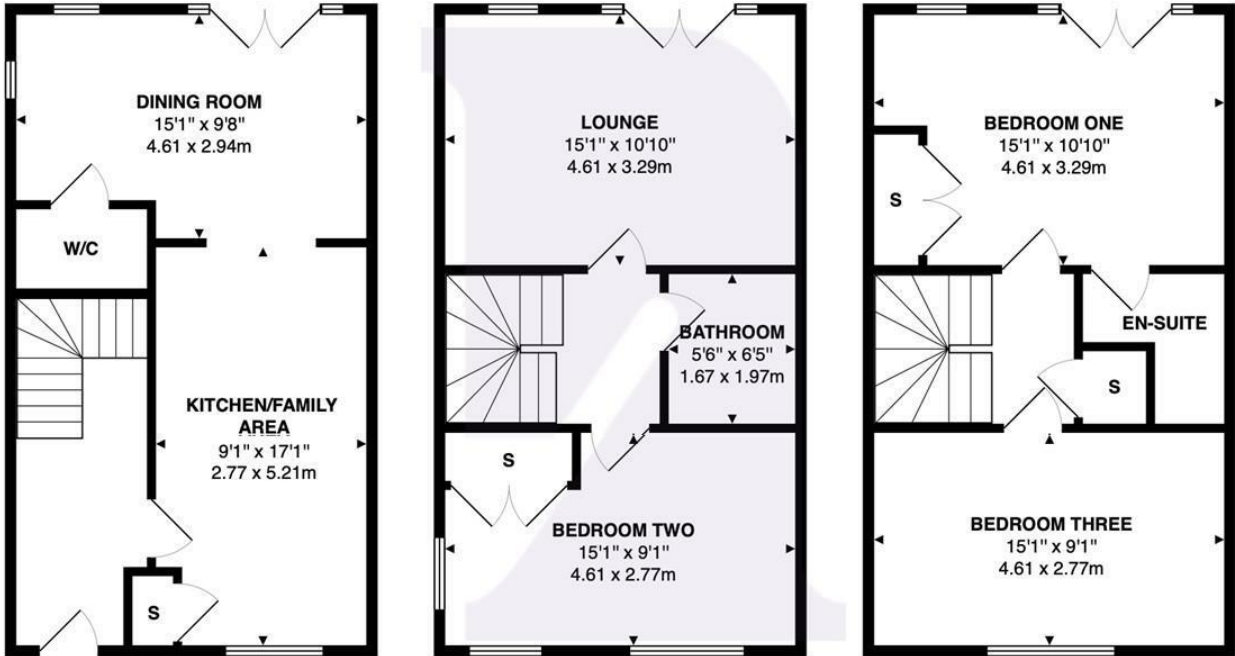

Total Area: 1231 ft<sup>2</sup> ... 114.4 m<sup>2</sup>  
All measurements are approximate and for display purposes only

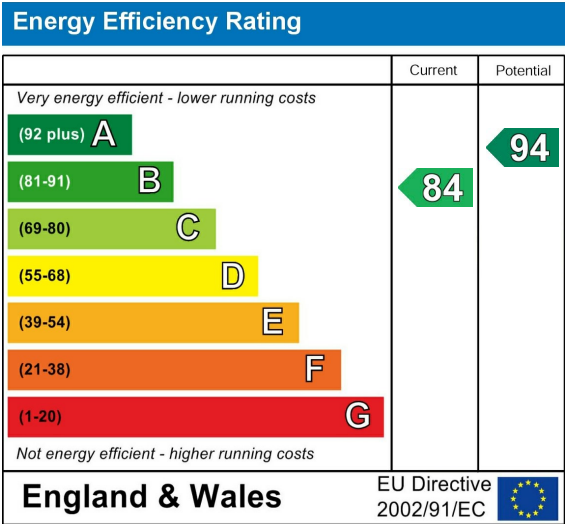

BARRY'S HOME FOR  
STYLISH SALES  
& LETTINGS



K N I G H T S